

# Double Reduction

## Helical / Worm Assemblies

### Styles DX & DXT

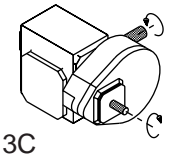
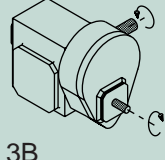
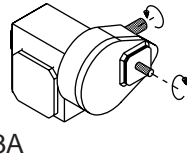
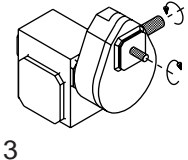
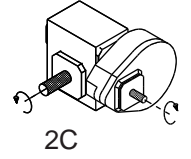
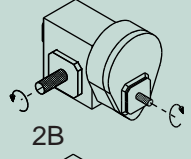
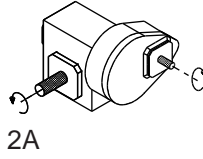
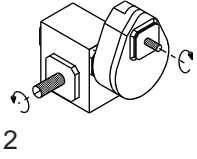
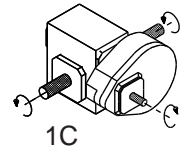
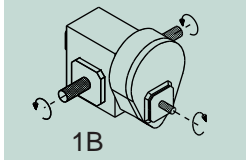
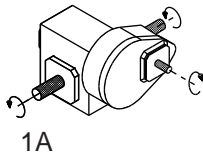
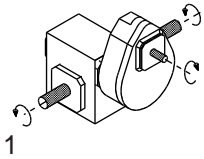

### Style DXU

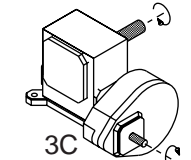
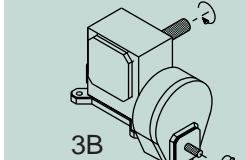
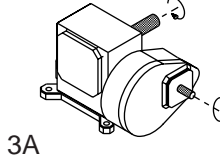
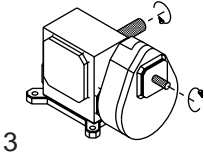
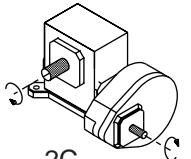
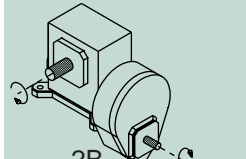
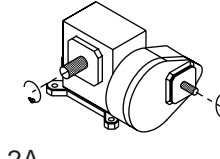
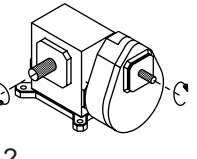
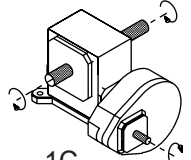
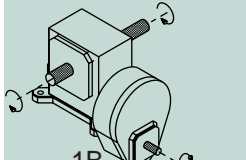
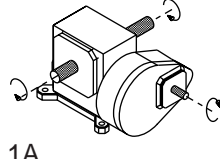
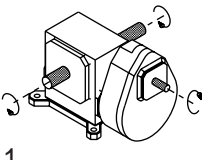

### Style DXJ

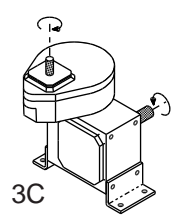
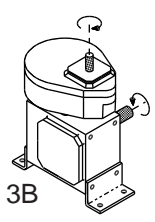
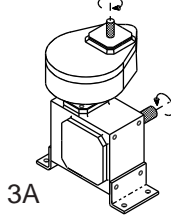
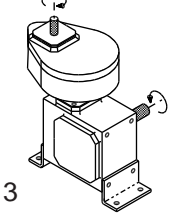
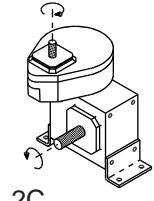
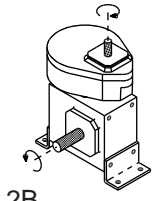
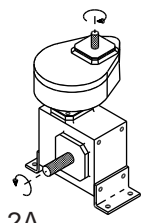
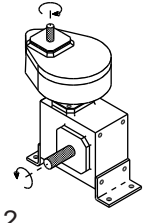
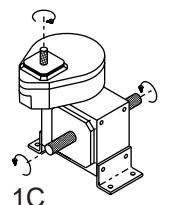
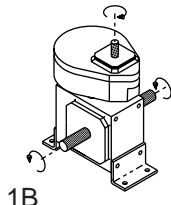
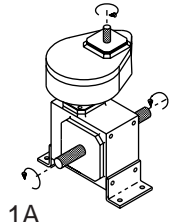
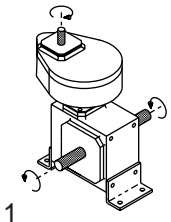

**GROVE GEAR**

# Double Reduction

## Helical / Worm Assemblies

### Styles DXV(L or H)

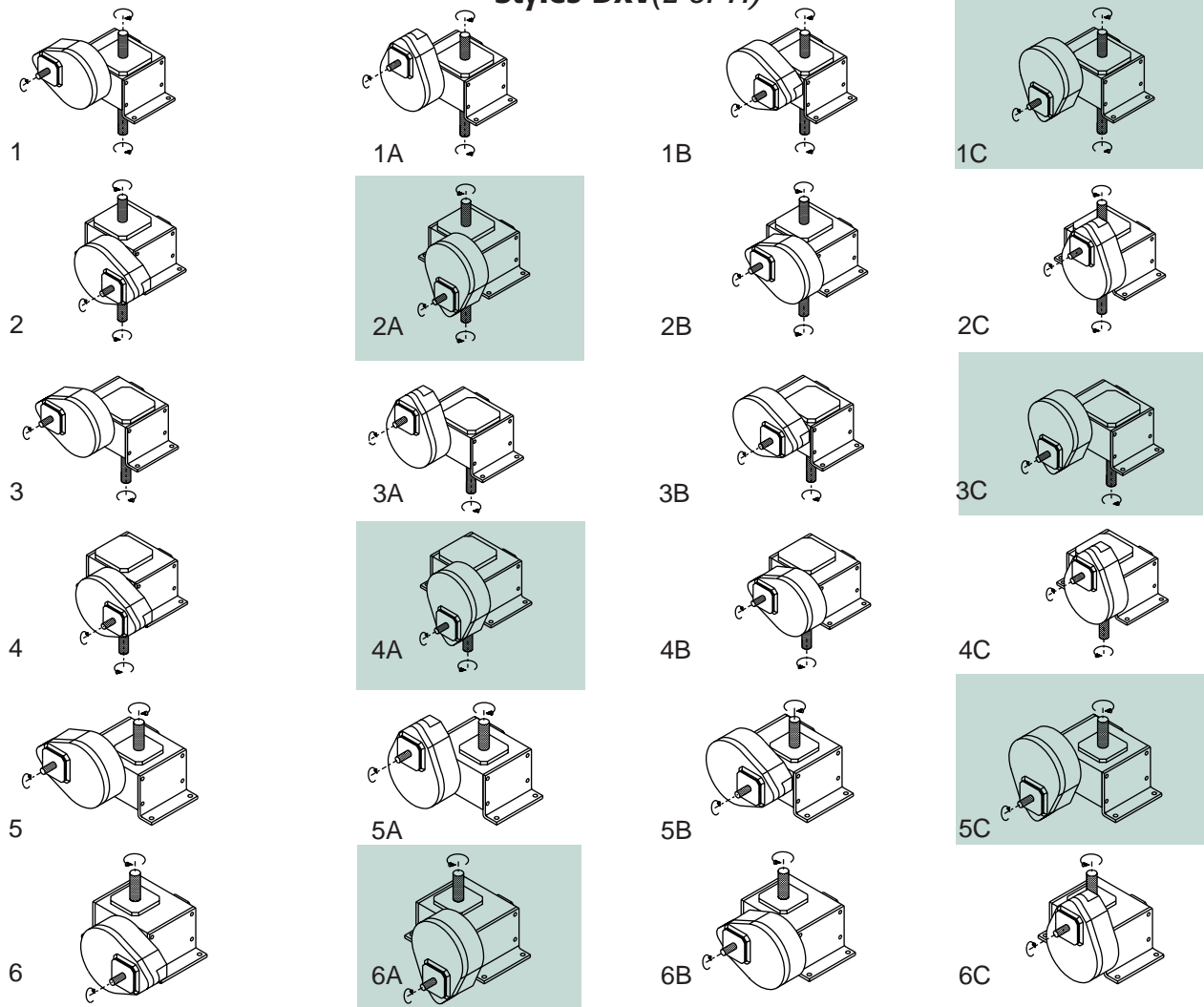

### Style DXFH

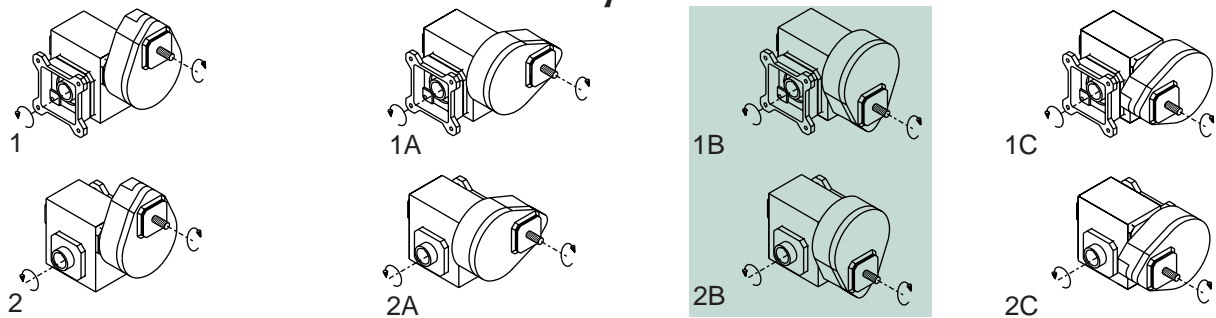

### Style DXH

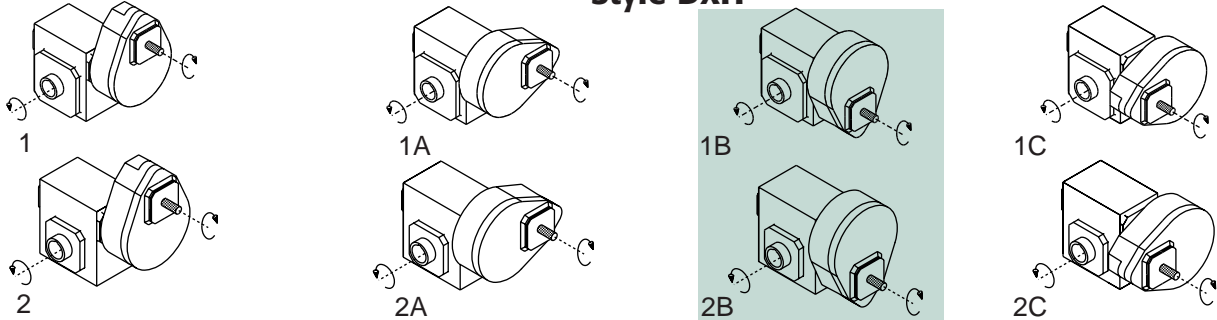

**Note:** The shaded mounting positions on assembly pages are not recommended due to the increased probability of leakage from high speed shaft seals. Assembly position options also apply to motor flange units ("MQ" and "M"). The input shaft may be rotated in either direction. Units are for mounting as shown. Contact factory for other mountings.

# Double Reduction

## Helical / Worm Assemblies

### Style DXF

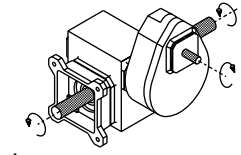

1

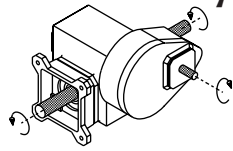

1A

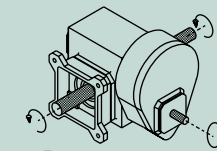

1B

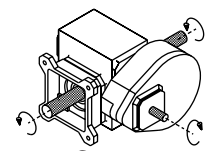

1C

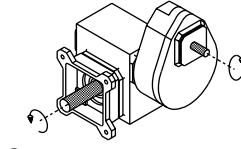

2

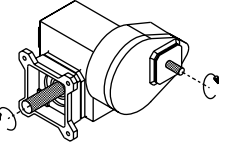

2A

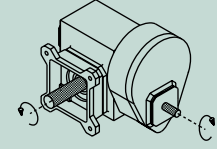

2B

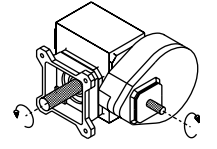

2C

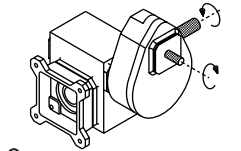

3

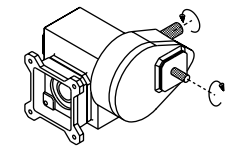

3A

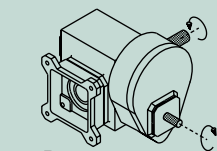

3B

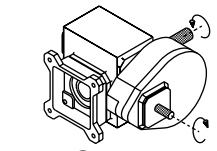

3C

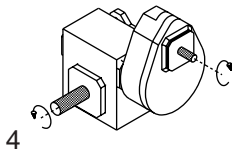

4

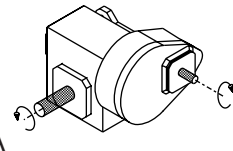

4A

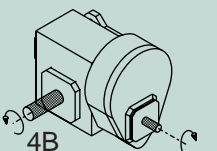

4B

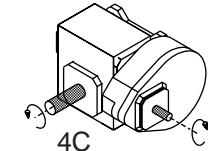

4C

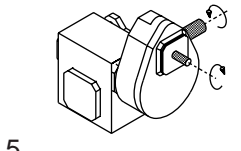

5

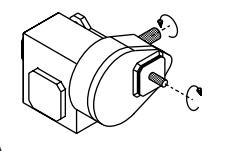

5A

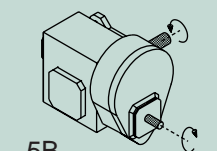

5B

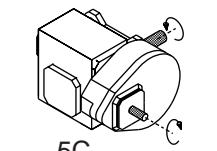

5C

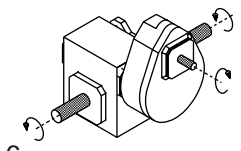

6

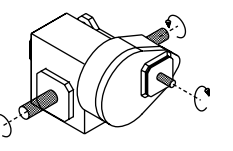

6A

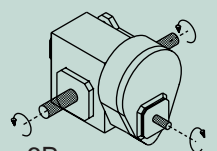

6B

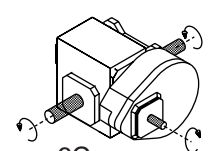

6C

### Style DXV(L or H)H

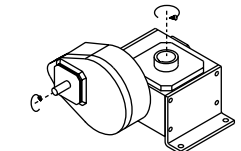

1

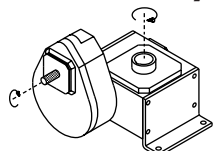

1A

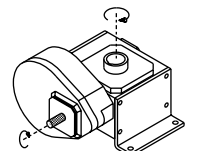

1B

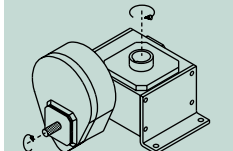

1C

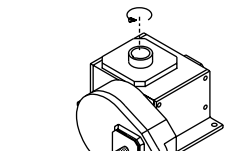

2

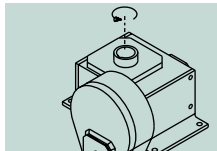

2A

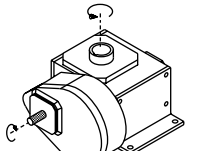

2B

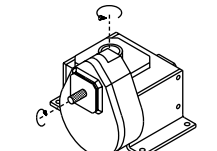

2C

### Style DXFE

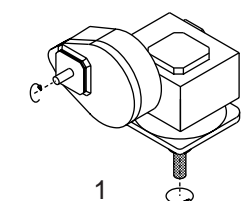

1

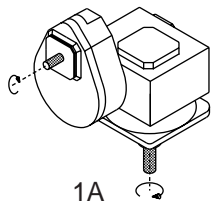

1A

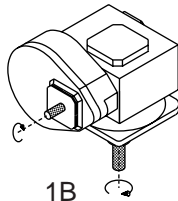

1B

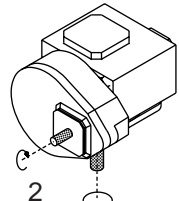

2

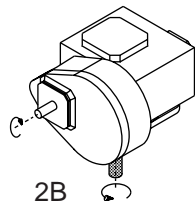

2B

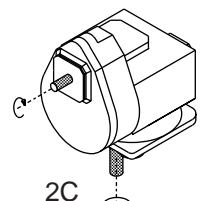

2C

**Note:** The shaded mounting positions on assembly pages are not recommended due to the increased probability of leakage from high speed shaft seals. Assembly position options also apply to motor flange units ("MQ" and "M"). The input shaft may be rotated in either direction. Units are for mounting as shown. Contact factory for other mountings.

**GROVE GEAR**

Davis Industries, Inc. Phone & Fax: 800-577-0559 E-mail: sales@davis-ohio.com